



Flat

# FLAT 1, 56-58 CROWNDALE ROAD, NW1 1TP

Per Month  
**£1,700**

Available: 6th January 2025

FEATURES



**Huddletons**

# 1 Bedroom Flat located in London

Huddletons are pleased to offer this fantastic one bedroom Flat set in a period building moments from Mornington Crescent Underground Station (Northern Line) and King's Cross International

£100pcm per person for gas, electric and water.

The property is set on the lower ground of a well maintained period building and benefits from a large bedroom/lounge, a separate kitchen and a bathroom together with use of a communal garden.

Perfect for a single professional, couple or a student.

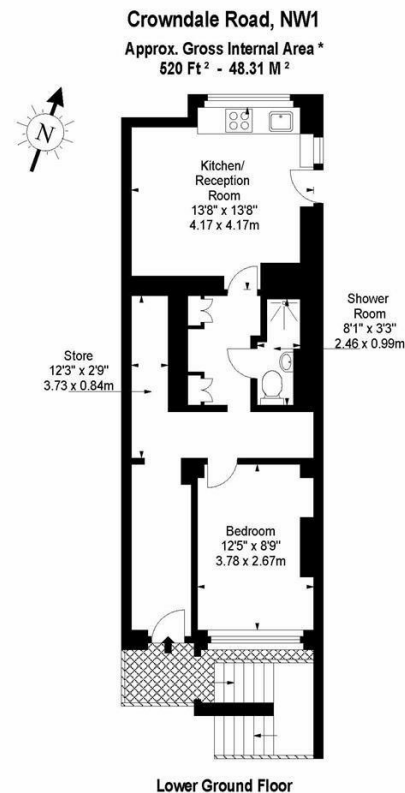

Every attempt has been made to ensure the accuracy of this floor plan however, measurements are approximate and for illustration purposes only. Measured in accordance with the RICS code of measuring practice. Not to scale

**Huddletons**  
PROPERTY - PEOPLE - PROGRESS

Call us on

**0207 205 4411**

**info@huddletons.com**

**<http://www.huddletons.com>**

**Council Tax Band**

Energy Efficiency Rating		
	Current	Potential
Very energy efficient - lower running costs		
(92 plus) <b>A</b>		
(81-91) <b>B</b>		
(69-80) <b>C</b>		
(55-68) <b>D</b>		
(39-54) <b>E</b>		
(21-38) <b>F</b>		
(1-20) <b>G</b>		
Not energy efficient - higher running costs		
England & Wales		EU Directive 2002/91/EC

Agents Note: Whilst every care has been taken to prepare these particulars, they are for guidance purposes only. All measurements are approximate and are for general guidance purposes only and whilst every care has been taken to ensure their accuracy, they should not be relied upon and potential buyers are advised to recheck the measurements.

# Huddletons